

4-0-44

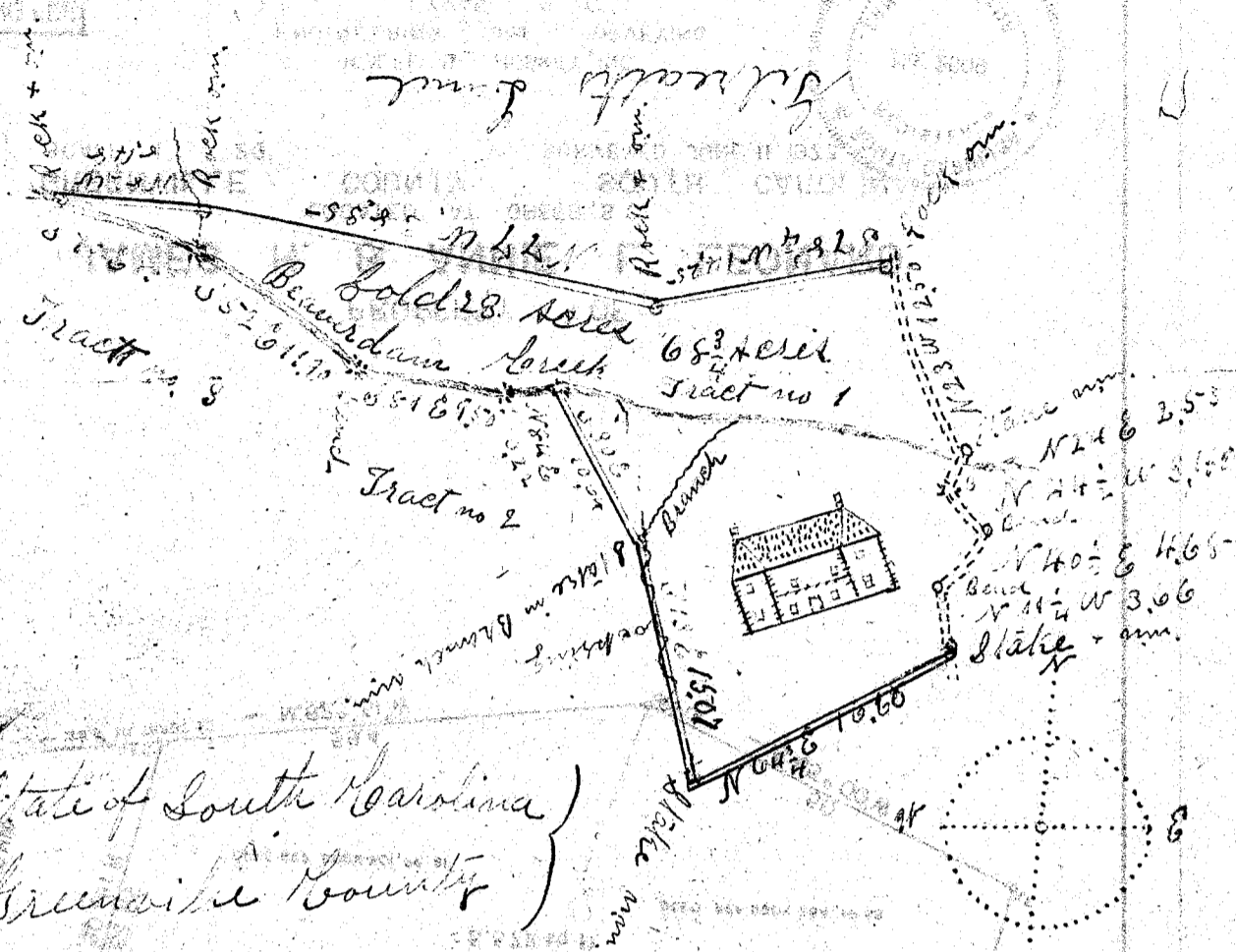

State of South Carolina
 Greenville County

Pursuant to a request of
 D. M. Kennerly I have surveyed and measured
 the above piece of land and find it to contain
 (68) Sixty Eight $\frac{3}{4}$ Acres and it hath such shape marks
 and boundaries as the above plat represents

Surveyed Dec. 12 1907
 W. A. Vester
 Surveyor

37846

POSTAGE
 PAID 08

RECORDING FEE
 PAID \$ 1.35

GREENVILLE CO. S. O.
 JUN 28 9 55 AM '73
 DONNIE S. TANKERSLEY
 R.M.C.

Plat recorded June 28, 1973
 at 9:55 AM #37846

68 3/4
 70
 139.0
 13
 13.75

1000